

1220/21

Gantrail Welded Base Fixing

www.gantrail.com



Gantrail®

A world of crane rail expertise

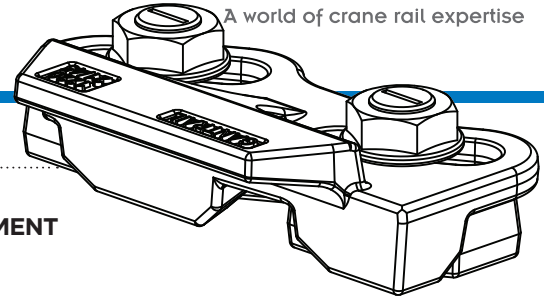

1220/21

The **GANTRAIL 1220/21** adjustable crane rail clip is designed to fix the largest rails in the most arduous applications. It can withstand a horizontal force from the rail of **300kN (30.6 tonnes)**, which is achieved through the unique double contact face. Its low profile allows it to be used with cranes that are fitted with guide rollers

SPECIFICATIONS:

MAX SIDE LOAD 300kN
21mm HORIZONTAL RAIL ADJUSTMENT

DIMENSIONS (mm):

| REF No. | X | Y | Z | WEIGHT kg |
|------------|----|----|----|-----------|
| 1220/21/38 | 38 | 47 | 31 | 2.40 |
| 1220/21/45 | 45 | 47 | 31 | 2.47 |
| 1220/21/52 | 52 | 47 | 31 | 2.54 |

FEATURES

- The new double contact face between the clip and rail allows for higher side loads.
- The clip has new pad retention geometry, which helps prevent pad migration.
- The clip is welded to the rail support. No access is required from below.
- The two main parts are locked together on tightening the grade 10.9 bolts.
- The clip has a self-tightening mechanism.
- A special vulcanised rubber block applies a controlled force to the rail.

COMPONENTS

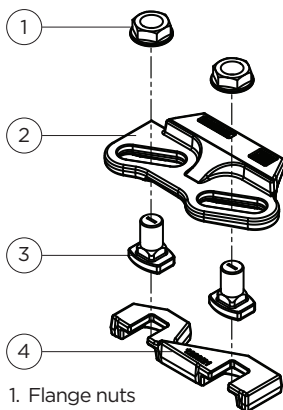

1. Flange nuts
2. Clip cap with integral rubber block
3. M20 Captive bolts
4. Weldable base

1 RAIL WITH PAD

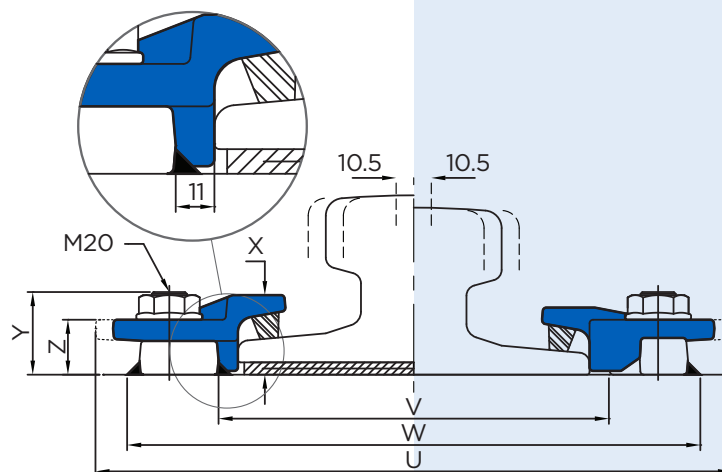

2 RAIL WITHOUT PAD*

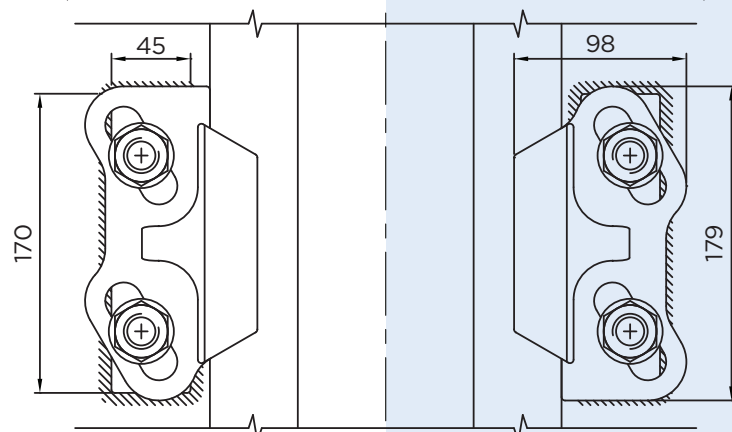

Minimum assembly width - $W = \text{Rail width (F)} + 130\text{mm}$ $V = \text{Rail width (F)} + 22\text{mm}$
 $U = \text{Rail width (F)} + 162\text{mm}$

1220/21

Gantrail Welded Base Fixing

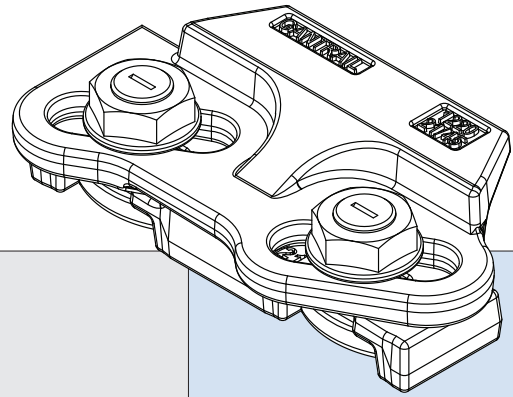

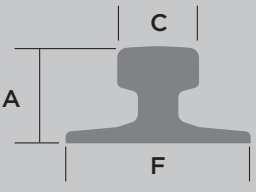
|  | F mm | C mm | A mm | 1. CLIP REFERENCE FOR RAIL WITH PAD | 2. CLIP REFERENCE FOR RAIL WITHOUT PAD* |
|---|---------|---------|---------|--|--|
| A 100 | 200 | 100 | 95 | 1220/21/45 | 1220/21/38 |
| A 120 | 220 | 120 | 105 | 1220/21/45 | 1220/21/38 |
| A 150 | 220 | 150 | 150 | 1220/21/45 | 1220/21/38 |
| 89 kg CR | 178 | 102 | 114 | 1220/21/45 | 1220/21/38 |
| MRS 86 | 165 | 102 | 102 | 1220/21/45 | 1220/21/38 |
| MRS 87 A (PRI85R) | 152 | 102 | 152 | 1220/21/45 | 1220/21/38 |
| MRS 125 | 180 | 120 | 180 | 1220/21/52 | 1220/21/45 |
| MRS 221 | 220 | 220 | 160 | 1220/21/52 | 1220/21/45 |
| ISCR 100 | 150 | 102 | 150 | 1220/21/45 | 1220/21/38 |
| ISCR 120 | 170 | 120 | 170 | 1220/21/45 | 1220/21/38 |
| ISCR 140 | 170 | 140 | 170 | 1220/21/52 | 1220/21/45 |
| QU 100 | 150 | 100 | 150 | 1220/21/45 | 1220/21/38 |
| QU 120 | 170 | 120 | 170 | 1220/21/45 | 1220/21/38 |
| ISCOR 57 | 140 | 70 | 165 | 1220/21/45 | 1220/21/38 |
| CR 73 | 140 | 100 | 135 | 1220/21/45 | 1220/21/38 |
| CR 100 | 155 | 120 | 150 | 1220/21/45 | 1220/21/38 |
| 73 kg AS | 146 | 70 | 157 | 1220/21/52 | 1220/21/45 |
| 86 kg AS | 165 | 102 | 102 | 1220/21/45 | 1220/21/38 |

This clip can be used for a wider selection of rails than illustrated.

Please contact GANTRAIL for the full range of possible rails. All rails can be fastened with bolted or welded base clips. GANTRAIL may change or improve their products and also alter specifications without notice.

INSTALLATION INSTRUCTIONS:

Fillet weld all round the clip base using low hydrogen electrodes. Refer to table for sizes. Recommended electrodes AWS E7018 or E7028. Clip base is made from weldable grade steel.

* For rail without pad, weld closest to and parallel with the rail must be omitted. Please consult Gantrail for guidance.

TIGHTENING TORQUE 350Nm

Please contact GANTRAIL, for full installation instructions.

WELD DETAIL

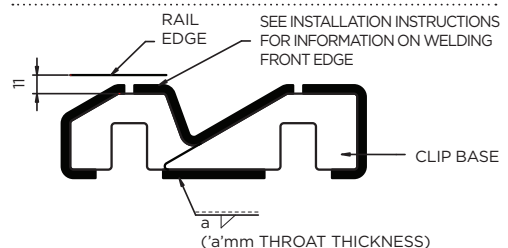

| 'a' mm | MAX SIDE LOAD kN |
|--------|------------------|
| 5 | 235 |
| 6 | 300 |

A world of crane rail expertise.

www.gantrail.com



Gantrail®
A world of crane rail expertise

Gantry Railing Ltd
Sudmeadow Road
Hempsted
Gloucester GL2 5HG
ENGLAND

Tel: +44 (0) 1452 300688
E-mail: info@gantrail.com



1220/21/DO/09/23